

LEGEND

- PROPERTY LINE
- FILING BOUNDARY
- LOT LINES
- POCKET PARK BOUNDARY
- RIGHT OF WAY
- EASEMENT
- EXISTING CONTOURS
- PROPOSED CONTOURS
- DECIDUOUS SHADE TREES
- ORNAMENTAL TREES
- EVERGREEN TREES
- SHRUBS
PERENNIALS/
ORNAMENTAL GRASSES
- SOD
- IRRIGATED TURF SEED
- NATIVE SEED
- LANDSCAPE BOULDER
- CRUSHER FINES
- ENGINEERED WOOD FIBER
- EDGER
- SPADE DUG EDGE
- MOW LINE
- GREENWAY FENCE
- BENCH
- TRASH RECEPTACLE
- 12x12' SHELTER
- PICNIC TABLE
- PET STATION
- BOUNDARY MARKER
- LPC LIGHT POLE
- REFERENCE NOTE

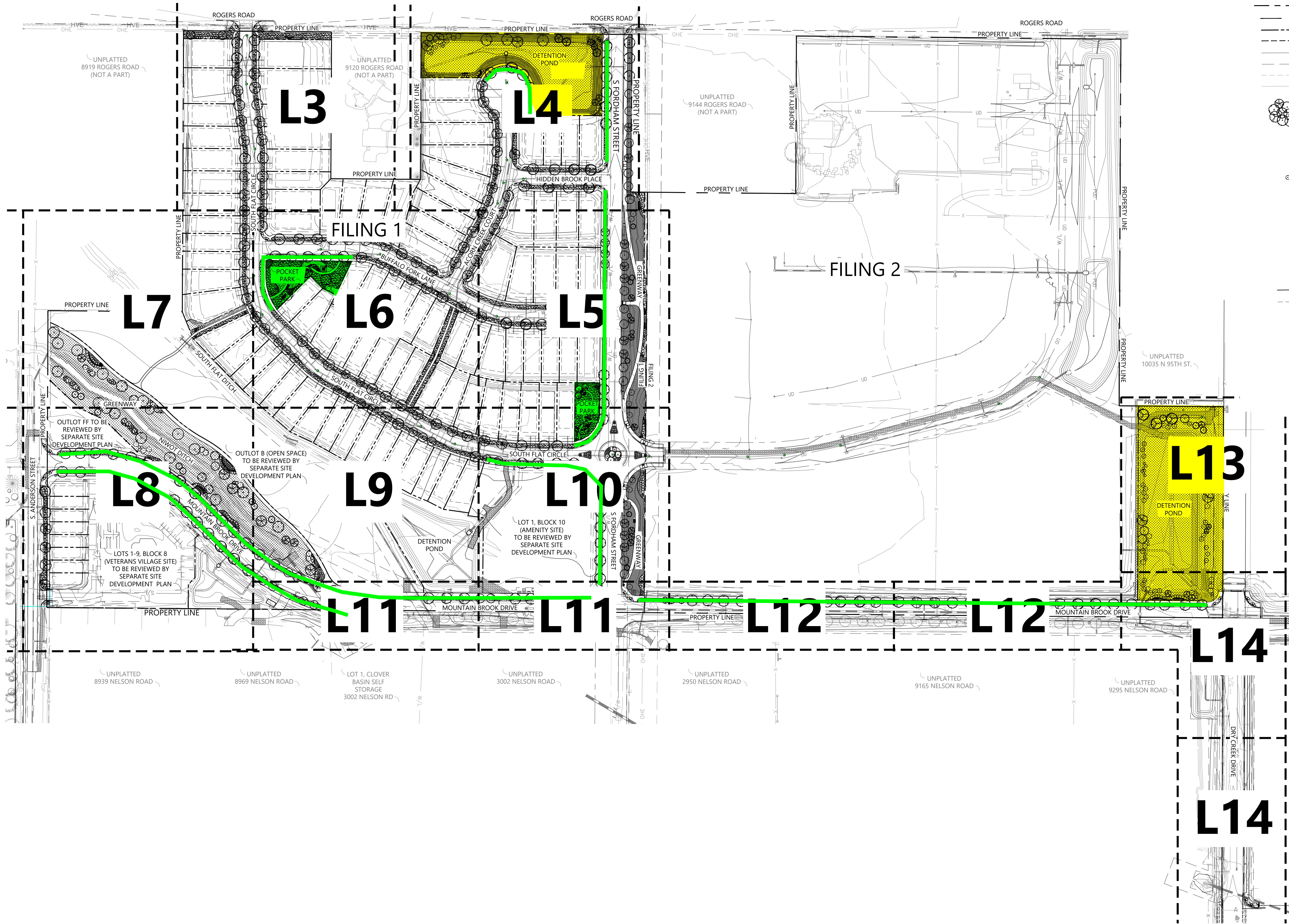

MOUNTAIN BROOK SUBDIVISION-FILING 1
 PUBLIC IMPROVEMENT PLANS
 LONGMONT, CO 80504

OWNER:
 MOUNTAIN BROOK
 PARTNERS, LLC
 6800 N. 79TH STREET
 NIWOT, CO 80503
 (720) 314-3517



DATE:
 08/22/19 SUBMITTAL
 02/06/20 SUBMITTAL
 08/06/20 SUBMITTAL
 12/03/20 SUBMITTAL
 02/18/21 SUBMITTAL
 04/02/21 SUBMITTAL
 04/22/21 MYLAR

SHEET TITLE:
 OVERALL
 LANDSCAPE PLAN

CHECKED BY: WB
 DRAWN BY: CS

